

# DEMİR PAMPHYLIA RESIDENCE



**Features of the complex:** Consists of 3 residential blocks, 72 apartments 2+1, 144 apartments 1+1, Outdoor Pool, Children's pool, Underground parking, Fitness, Sauna, Football field, Tennis court, Gazebos, Recreation areas, Surveillance cameras, generators.

**Features of the apartments:** Air conditioners brand "Siemens", CNC lacquered doors, Kitchen appliances (oven, hob, extractor) brand "Siemens", automatic shutters, kitchen furniture.

**Completion date:** End of the first quarter of 2025. **Down payment 50%**, installment plan 18 months

## B BLOK

		DOĞU - EAST						
11 KAT	KUZEY - NORT	№72 2+1 98m2(73,5m2) SOLD D	№71 1+1 72m2(51,5m2) SOLD	№70 1+1 72m2(51,5m2) 222.000 EUR	№69 1+1 72m2(51,5m2) SOLD	№68 1+1 72m2(51,5m2) 222.000 EUR	№67 2+1 98m2(73,5m2) SOLD	GÜNEY - SOUT
	BATI - WEST							
10 KAT	KUZEY - NORT	№66 2+1 98m2(73,5m2) SOLD D	№65 1+1 72m2(51,5m2) SOLD D	№64 1+1 72m2(51,5m2) SOLD	№63 1+1 72m2(51,5m2) 217.000 EUR	№62 1+1 72m2(51,5m2) 217.000 EUR	№61 2+1 98m2(73,5m2) 259.000 EUR	GÜNEY - SOUT
	BATI - WEST							
9 KAT	KUZEY - NORT	№60 2+1 98m2(73,5m2) 254.000 EUR	№59 1+1 72m2(51,5m2) SOLD	№58 1+1 72m2(51,5m2) 212.000 EUR	№57 1+1 72m2(51,5m2) SOLD	№56 1+1 72m2(51,5m2) 212.000 EUR	№55 2+1 98m2(73,5m2) SOLD	GÜNEY - SOUT
	BATI - WEST							
8 KAT	KUZEY - NORT	№54 2+1 98m2(73,5m2) 249.000 EUR	№53 1+1 72m2(51,5m2) 207.000 EUR	№52 1+1 72m2(51,5m2) SOLD	№51 1+1 72m2(51,5m2) 207.000 EUR	№50 1+1 72m2(51,5m2) 207.000 EUR	№49 2+1 98m2(73,5m2) 249.000 EUR	GÜNEY - SOUT
	BATI - WEST							
7 KAT	KUZEY - NORT	№48 2+1 98m2(73,5m2) 244.000 EUR	№47 1+1 72m2(51,5m2) 202.000 EUR	№46 1+1 72m2(51,5m2) 202.000 EUR	№45 1+1 72m2(51,5m2) SOLD	№44 1+1 72m2(51,5m2) 202.000 EUR	№43 2+1 98m2(73,5m2) SOLD	GÜNEY - SOUT
	BATI - WEST							
6 KAT	KUZEY - NORT	№42 2+1 98m2(73,5m2) SOLD	№41 1+1 72m2(51,5m2) 197.000 EUR	№40 1+1 72m2(51,5m2) SOLD	№39 1+1 72m2(51,5m2) 197.000 EUR	№38 1+1 72m2(51,5m2) 197.000 EUR	№37 2+1 98m2(73,5m2) 239.000 EUR	GÜNEY - SOUT
	BATI - WEST							
5 KAT	KUZEY - NORT	№36 2+1 98m2(73,5m2) 234.000 EUR	№35 1+1 72m2(51,5m2) SOLD	№34 1+1 72m2(51,5m2) 192.000 EUR	№33 1+1 72m2(51,5m2) SOLD	№32 1+1 72m2(51,5m2) 192.000 EUR	№31 2+1 98m2(73,5m2) SOLD	GÜNEY - SOUT
	BATI - WEST							

HAVALIMANI - АЭРОПОРТ

	DOĞU - EAST							
KUZEY - NORT	4 KAT	№30 2+1 98m2(73,5m2) SOLD *	№29 1+1 72m2(51,5m2) 187.000 EUR	№28 1+1 72m2(44,5m2) 187.000 EUR	№27 1+1 72m2(51,5m2) 187.000 EUR	№26 1+1 72m2(51,5m2) SOLD *	№25 2+1 98m2(73,5m2) SATILDI	GÜNEY - SOUT
		BATI - WEST						
		DOĞU - EAST						
KUZEY - NORT	3 KAT	№24 2+1 98m2(73,5m2) 224.000 EUR	№23 1+1 72m2(51,5m2) 182.000 EUR	№22 1+1 72m2(51,5m2) 182.000 EUR	№21 1+1 72m2(51,5m2) SOLD *	№20 1+1 72m2(51,5m2) 182.000 EUR	№19 2+1 98m2(73,5m2) SOLD *	GÜNEY - SOUT
		BATI - WEST						
		DOĞU - EAST						
KUZEY - NORT	2 KAT	№18 2+1 98m2(73,5m2) SOLD *	№17 1+1 72m2(51,5m2) 177.000 EUR	№16 1+1 72m2(51,5m2) 177.000 EUR	№15 1+1 72m2(51,5m2) 177.000 EUR	№14 1+1 72m2(51,5m2) 177.000 EUR	№13 2+1 98m2(73,5m2) SOLD	GÜNEY - SOUT
		BATI - WEST						
		DOĞU - EAST						
KUZEY - NORT	1 KAT	№12 2+1 98m2(73,5m2) SOLD	№11 1+1 72m2(51,5m2) SOLD *	№10 1+1 72m2(51,5m2) 172.000 EUR	№9 1+1 72m2(51,5m2) SOLD *	№8 1+1 72m2(51,5m2) 172.000 EUR	№7 2+1 98m2(73,5m2) SOLD *	GÜNEY - SOUT
		BATI - WEST						
		DOĞU - EAST						
KUZEY - NORT	ground floor	№6 2+1 98m2(73,5m2) SOLD *	№5 1+1 72m2(51,5m2) 228.000 EUR	№4 1+1 72m2(51,5m2) SOLD *	№3 1+1 72m2(51,5m2) 228.000 EUR	№2 1+1 72m2(51,5m2) 228.000 EUR	№1 2+1 98m2(73,5m2) 288.000 EUR	GÜNEY - SOUT
		BATI - WEST						



# C BLOK

HAVALIMANI - АЭРОПОРТ

KAT	BATI - WEST	KUZEY - NORTH	DOĞU - EAST
11 KAT	№72 2+1 98m2(73,5m2) 264.000 EUR	№71 1+1 72m2(51,5m2) 222.000 EUR	№70 1+1 72m2(51,5m2) 222.000 EUR
		№69 1+1 72m2(51,5m2) SATILDI D	№68 1+1 72m2(51,5m2) SATILDI D
			№67 2+1 98m2(73,5m2) SATILDI D
		GÜNEY - SOUTH	
10 KAT	№66 2+1 98m2(73,5m2) 259.000 EUR	№65 1+1 72m2(51,5m2) 217.000 EUR	№64 1+1 72m2(51,5m2) 217.000 EUR
		№63 1+1 72m2(51,5m2) SATILDI D	№62 1+1 72m2(51,5m2) SATILDI D
			№61 2+1 98m2(73,5m2) SATILDI D
		GÜNEY - SOUTH	
9 KAT	№60 2+1 98m2(73,5m2) 254.000 EUR	№59 1+1 72m2(51,5m2) 212.000 EUR	№58 1+1 72m2(51,5m2) 212.000 EUR
		№57 1+1 72m2(51,5m2) 212.000 EUR	№56 1+1 72m2(51,5m2) 212.000 EUR
			№55 2+1 98m2(73,5m2) 254.000 EUR
		GÜNEY - SOUTH	
8 KAT	№54 2+1 98m2(73,5m2) 249.000 EUR	№53 1+1 72m2(51,5m2) 207.000 EUR	№52 1+1 72m2(51,5m2) 207.000 EUR
		№51 1+1 72m2(51,5m2) 207.000 EUR	№50 1+1 72m2(51,5m2) 207.000 EUR
			№49 2+1 98m2(73,5m2) 249.000 EUR
		GÜNEY - SOUTH	
7 KAT	№48 2+1 98m2(73,5m2) 244.000 EUR	№47 1+1 72m2(51,5m2) 202.000 EUR	№46 1+1 72m2(51,5m2) 202.000 EUR
		№45 1+1 72m2(51,5m2) 202.000 EUR	№44 1+1 72m2(51,5m2) 202.000 EUR
			№43 2+1 98m2(73,5m2) 244.000 EUR
		GÜNEY - SOUTH	
6 KAT	№42 2+1 98m2(73,5m2) SOLD	№41 1+1 72m2(51,5m2) 197.000 EUR	№40 1+1 72m2(51,5m2) 197.000 EUR
		№39 1+1 72m2(51,5m2) 197.000 EUR	№38 1+1 72m2(51,5m2) 197.000 EUR
			№37 2+1 98m2(73,5m2) 239.000 EUR
		GÜNEY - SOUTH	
5 KAT	№36 2+1 98m2(73,5m2) 234.000 EUR	№35 1+1 72m2(51,5m2) 192.000 EUR	№34 1+1 72m2(51,5m2) 192.000 EUR
		№33 1+1 72m2(51,5m2) 192.000 EUR	№32 1+1 72m2(51,5m2) 192.000 EUR
			№31 2+1 98m2(73,5m2) 234.000 EUR
		GÜNEY - SOUTH	
4 KAT	№30 2+1 98m2(73,5m2) 229.000 EUR	№29 1+1 72m2(51,5m2) 187.000 EUR	№28 1+1 72m2(51,5m2) 187.000 EUR
		№27 1+1 72m2(51,5m2) 187.000 EUR	№26 1+1 72m2(51,5m2) 187.000 EUR
			№25 2+1 98m2(73,5m2) 229.000 EUR
		GÜNEY - İOĞ	

АЭРОПОРТ

BATI - WEST

3 KAT

KUZEY - NORTH					
№24 2+1 98m2(73,5m2) 224.000 EUR	№23 1+1 72m2(51,5m2) 182.000 EUR	№22 1+1 72m2(51,5m2) 182.000 EUR	№21 1+1 72m2(51,5m2) 182.000 EUR	№20 1+1 72m2(51,5m2) 182.000 EUR	№19 2+1 98m2(73,5m2) 224.000 EUR

DOĞU - EAST

HAVALİMANI

BATI - WEST

2 KAT

KUZEY - NORTH					
№18 2+1 98m2(73,5m2) 219.000 EUR	№17 1+1 72m2(51,5m2) 177.000 EUR	№16 1+1 72m2(51,5m2) 177.000 EUR	№15 1+1 72m2(51,5m2) 177.000 EUR	№14 1+1 72m2(51,5m2) 177.000 EUR	№13 2+1 98m2(73,5m2) 219.000 EUR

DOĞU - EAST

BATI - WEST

1 KAT

KUZEY - NORTH					
№12 2+1 98m2(73,5m2) 214.000 EUR	№11 1+1 72m2(51,5m2) 172.000 EUR	№10 1+1 72m2(51,5m2) 172.000 EUR	№9 1+1 72m2(51,5m2) 172.000 EUR	№8 1+1 72m2(51,5m2) 172.000 EUR	№7 2+1 98m2(73,5m2) 214.000 EUR

DOĞU - EAST

BATI - WEST

ZEMİN  
KAT

KUZEY - NORTH					
№6 2+1 98m2(73,5m2) 288.000 EUR	№5 1+1 72m2(51,5m2) 228.000 EUR	№4 1+1 72m2(51,5m2) 228.000 EUR	№3 1+1 72m2(51,5m2) 228.000 EUR	№2 1+1 72m2(51,5m2) 228.000 EUR	№1 2+1 98m2(73,5m2) 288.000 EUR

DOĞU - EAST

GÜNEY - SOUTH

A-BLOK

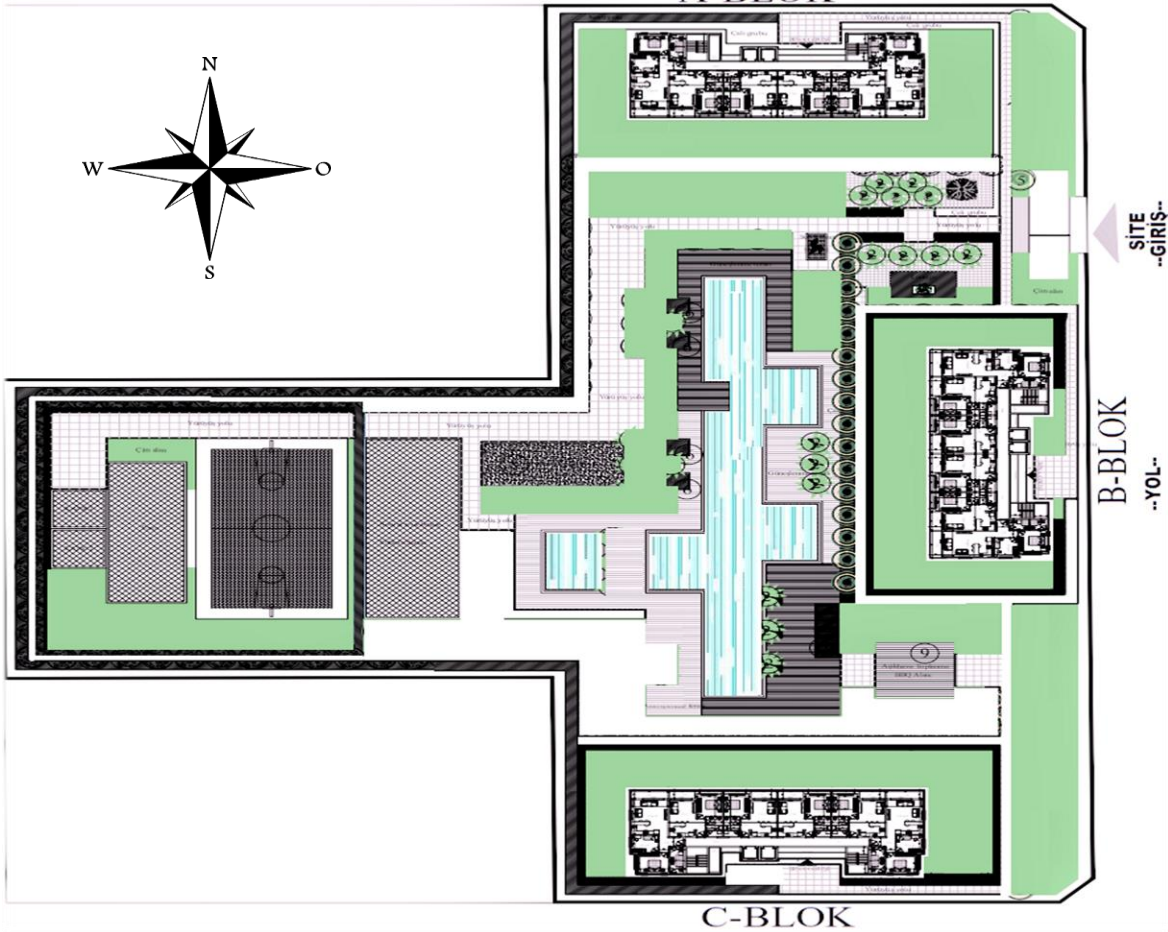

АЭРОПОРТ

HAVALİMANI